

PROJECT REFERENCE NO.	SHEET NO.
US74A TURN LANE - 81	1 OF 1
ROADWAY DESIGN ENGINEER	PAVEMENT DESIGN ENGINEER

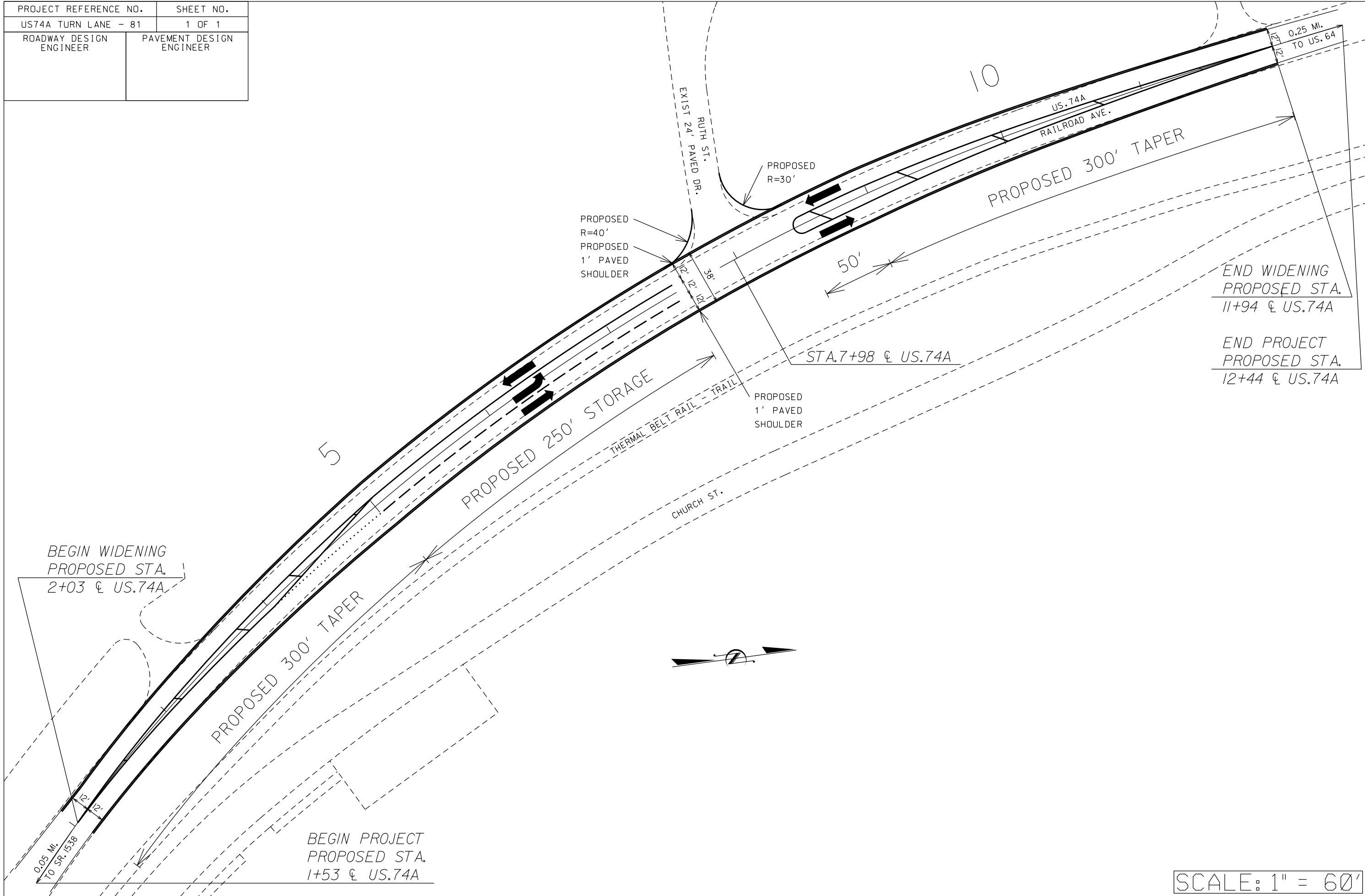

END WIDENING  
PROPOSED STA.  
11+94 @ US.74A

END PROJECT  
PROPOSED STA.  
12+44 @ US.74A

SCALE: 1" = 60'

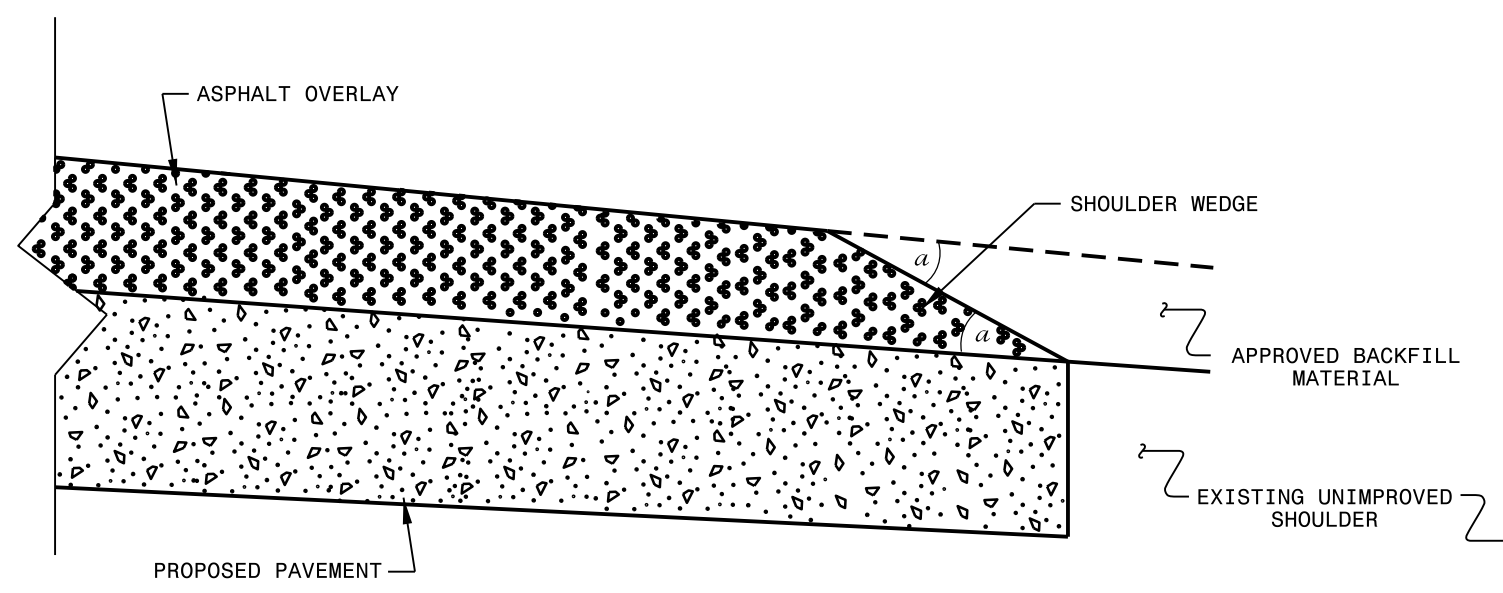

### SHOULDER WEDGE DETAIL

(Resurfacing Projects w/ Widening or with Existing Paved Shoulder > 2 ft.)

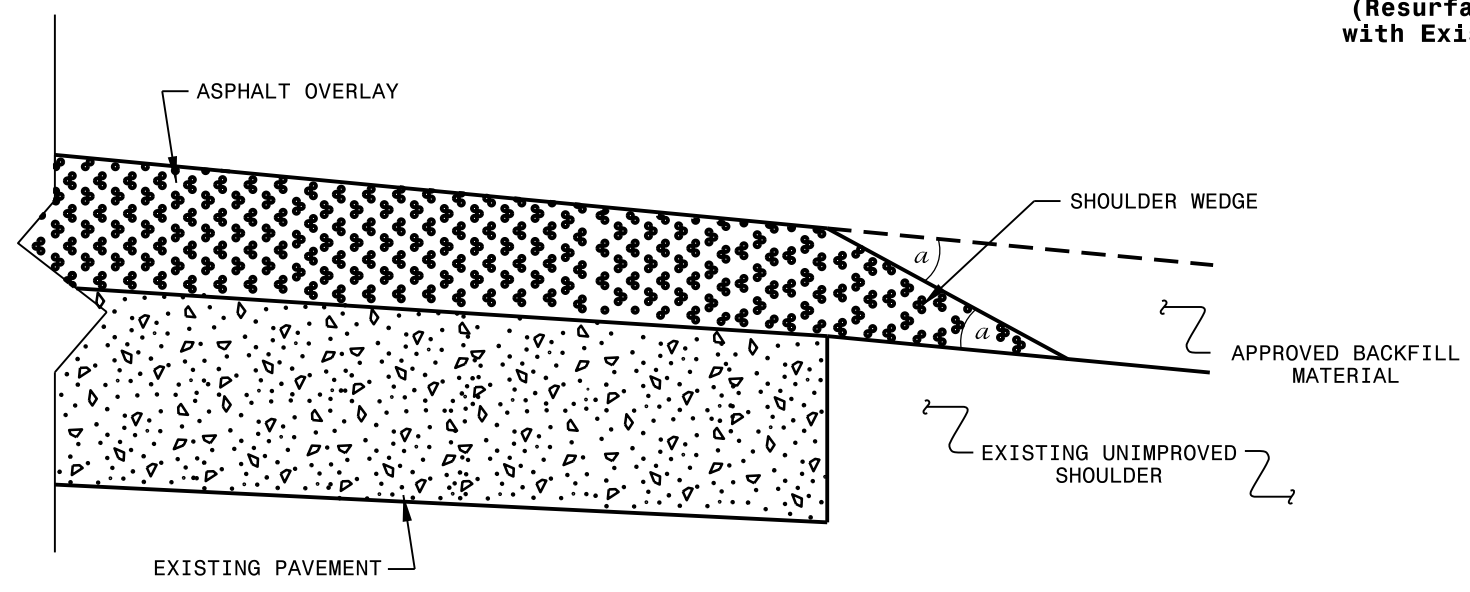

### SHOULDER WEDGE DETAIL

(Resurfacing Projects w/ NO Widening)

- NOTES:
- 1) DETAIL DOES NOT APPLY TO OGAFB AND ULTRA-THIN BONDED WEARING COURSE.
  - 2) BACKFILL SHOULDER WITH APPROVED MATERIAL.
  - 3) THE SHOULDER WEDGE DEVICE MAY BE DISENGAGED AT PAVED DRIVEWAYS AND SIDE STREETS.

$a$  - SHOULDER WEDGE ANGLE = 30°

<b>CONTRACT STANDARDS AND DEVELOPMENT UNIT</b>	
Office 919-707-6950 FAX 919-250-4119	
<b>SHOULDER WEDGE DETAILS</b>	
ORIGINAL BY: T.SPELL	DATE: 7-19-11
MODIFIED BY:	DATE: 10/16/12
CHECKED BY:	DATE:
FILE SPEC.: susr/details/stand/shoulderwedgedetail.dgn	

SYSTEMS DESIGN CONSULTANTS  
 11000 WILSON BLVD  
 SUITE 100  
 FARMERSVILLE, NC 27834  
 TEL: 919-707-6950  
 FAX: 919-250-4119  
 WWW.SDCON.COM

PAVEMENT SCHEDULE	
CI	PROP. APPROX. 1.5" ACSC, TYPE S9.5B, AT AN AVERAGE RATE OF 168 LBS PER SQ.YD.
DI	PROP. APPROX. 4" ACIC, TYPE I19.0B, AT AN AVERAGE RATE OF 456 LBS PER SQ.YD.
EI	PROP. APPROX. 4" ACBC, TYPE B25.0B, AT AN AVERAGE RATE OF 456 LBS PER SQ.YD.

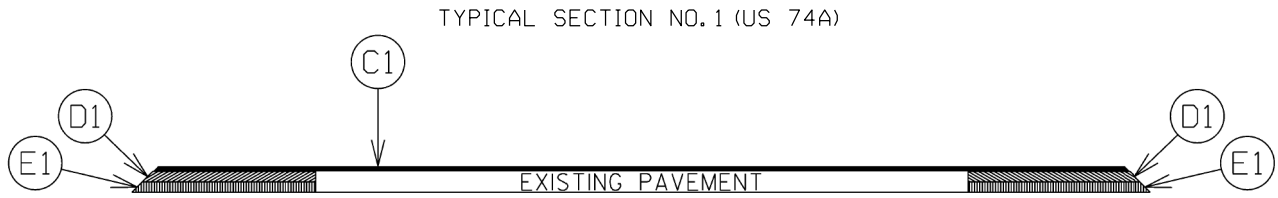

NOTE:  
WIDENING OF ASPHALT PAVEMENT WIDTH VARIES FROM  
0 TO 6 FEET ON EACH SIDE OF (US 74A)

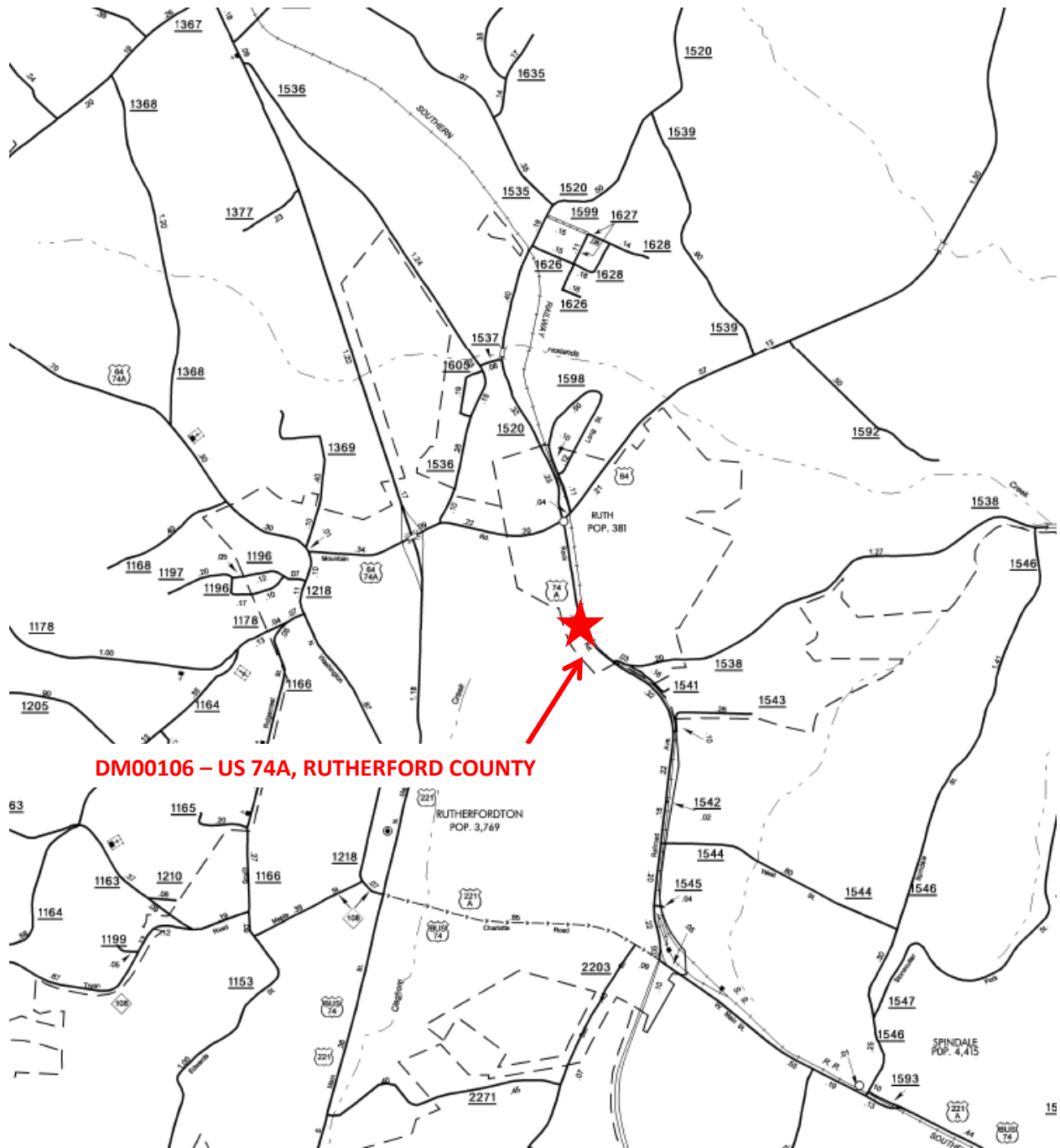

**DM00106 – US 74A, RUTHERFORD COUNTY**